



Huntsville, Alabama

305 Fountain Circle
Huntsville, AL 35801

Cover Memo

Meeting Type: City Council Regular Meeting **Meeting Date:** 1/9/2025

File ID: TMP-5075

Department: Planning

Subject:

Type of Action: Introduction

Introduction of an ordinance annexing 394.93 acres of land lying on the south side of AL Hwy 20 and east of I-65.

Ordinance No.

Does this item need to be published? Yes

If yes, please list preferred date(s) of publication: January 29, 2025

Finance Information:

Account Number: n/a

City Cost Amount: \$ 0

Total Cost: \$ 0

Special Circumstances:

Grant Funded: \$ 0

Grant Title - CFDA or granting Agency: n/a

Resolution #: n/a

Location:

Address: Arrowhead Landing Rd, Mooresville, AL 35649

District: District 1 ☐ District 2 ☐ District 3 ☐ District 4 ☐ District 5 ☐

Additional Comments: none

ORDINANCE NO. 25-

WHEREAS, The City of Huntsville, Alabama, by Tommy Battle, as its Mayor, being the owner, as the term is defined by Section 11-42-20, Code of Alabama 1975, of all the property or territory hereinafter particularly described (which property or territory is hereinafter referred to as “the Property”), filed with the City Clerk of the City of Huntsville, Alabama, a signed and written petition requesting that the Property be annexed to the City of Huntsville, Alabama, which petition is on file with the City Clerk of the City of Huntsville, Alabama; and

WHEREAS, said petition contained the signature of the owner of the Property, and filed together with said petition was a map showing the relationship of the Property to the corporate limits of the City of Huntsville, Alabama, which map is attached hereto and incorporated herein by reference; and

WHEREAS, the Property is contiguous to the present city limits of the City of Huntsville, Alabama, and the Property does not lie within the corporate limits or police jurisdiction of any other municipality; and

WHEREAS, the City Council of the City of Huntsville, Alabama, has determined that it is necessary and proper and in the public interest that the Property be brought within the corporate limits of the City of Huntsville, Alabama, and has further determined that all legal requirements for annexing the Property have been met pursuant to Sections 11-42-20 through 11-42-24, Code of Alabama 1975.

NOW, THEREFORE, BE IT ORDAINED by the City Council of the City of Huntsville, Alabama, as follows:

1. That the City Council of the City of Huntsville, Alabama hereby finds that it is necessary and proper and in the public interest that the Property be brought within the corporate limits of the City of Huntsville, Alabama, and assents to the annexation of the Property to the City of Huntsville, Alabama;

2. That the corporate limits of the City of Huntsville, Alabama, be, and the same are hereby extended and rearranged so as to embrace and include the Property, which is particularly described as follows:

All that part of Sections 06, 07 and 18, Township 5 South, Range 3 West of the Huntsville Meridian, Limestone County, Alabama more particularly described as beginning at a point located at the southwest corner of said Section 06; thence North 1 Degrees 42 Minutes 30 Seconds East 347.33 feet to a point; said point is further described as the Point of True Beginning; thence South 86 Degrees 44 Minutes 3 Seconds East 314.47 feet to a point; thence South 46 Degrees 48 Minutes 28 Seconds East 571.02 feet to a point; thence South 88 Degrees 34 Minutes 30 Seconds East 1133.8 feet to a point; thence South 88 Degrees 33 Minutes 59 Seconds East 189.5 feet to a point; thence South 4 Degrees 11 Minutes 10 Seconds West 195.62 feet to a point; thence South 0 Degrees 33 Minutes 2 Seconds West 290.67 feet to a point; thence South 3 Degrees 47 Minutes 43 Seconds West 168.97 feet to a point; thence South 23 Degrees 20 Minutes 55 Seconds East 97.07 feet to a point; thence South 29 Degrees 6 Minutes 18 Seconds East 16.2 feet to a point; thence South 30 Degrees 44 Minutes 58 Seconds East

16.2 feet to a point; thence South 28 Degrees 4 Minutes 52 Seconds East 293.31 feet to a point; thence South 87 Degrees 23 Minutes 31 Seconds East 239.89 feet to a point; thence South 0 Degrees 18 Minutes 22 Seconds West 268.82 feet to a point; thence South 89 Degrees 8 Minutes 40 Seconds East 230.48 feet to a point; thence South 24 Degrees 22 Minutes 9 Seconds East 1247.71 feet to a point; thence South 1 Degrees 37 Minutes 21 Seconds West 521.37 feet to a point; thence North 88 Degrees 52 Minutes 17 Seconds West 527.77 feet to a point; thence South 2 Degrees 30 Minutes 36 Seconds West 51.62 feet to a point; thence South 1 Degrees 58 Minutes 33 Seconds West 51.62 feet to a point; thence South 1 Degrees 26 Minutes 25 Seconds West 51.62 feet to a point; thence South 0 Degrees 54 Minutes 20 Seconds West 51.62 feet to a point; thence South 0 Degrees 22 Minutes 15 Seconds West 51.62 feet to a point; thence South 0 Degrees 9 Minutes 50 Seconds East 51.62 feet to a point; thence South 4 Degrees 38 Minutes 29 Seconds East 15.44 feet to a point; thence South 2 Degrees 59 Minutes 21 Seconds East 15.44 feet to a point; thence South 1 Degrees 20 Minutes 17 Seconds East 15.44 feet to a point; thence South 0 Degrees 18 Minutes 51 Seconds West 15.44 feet to a point; thence South 1 Degrees 57 Minutes 51 Seconds West 15.44 feet to a point; thence South 3 Degrees 37 Minutes 2 Seconds West 15.44 feet to a point; thence South 5 Degrees 16 Minutes 6 Seconds West 15.44 feet to a point; thence South 6 Degrees 55 Minutes 12 Seconds West 15.44 feet to a point; thence South 8 Degrees 34 Minutes 18 Seconds West 15.44 feet to a point; thence South 13 Degrees 25 Minutes 34 Seconds West 9.5 feet to a point; thence South 16 Degrees 20 Minutes 38 Seconds West 9.5 feet to a point; thence South 19 Degrees 15 Minutes 40 Seconds West 9.5 feet to a point; thence South 22 Degrees 10 Minutes 20 Seconds West 9.5 feet to a point; thence South 25 Degrees 5 Minutes 16 Seconds West 9.5 feet to a point; thence South 28 Degrees 0 Minutes 15 Seconds West 9.5 feet to a point; thence South 30 Degrees 55 Minutes 5 Seconds West 9.5 feet to a point; thence South 33 Degrees 50 Minutes 2 Seconds West 9.5 feet to a point; thence South 36 Degrees 45 Minutes 3 Seconds West 9.5 feet to a point; thence South 39 Degrees 39 Minutes 56 Seconds West 9.5 feet to a point; thence South 42 Degrees 34 Minutes 43 Seconds West 9.5 feet to a point; thence South 45 Degrees 29 Minutes 38 Seconds West 9.5 feet to a point; thence South 45 Degrees 50 Minutes 27 Seconds West 11.07 feet to a point; thence South 48 Degrees 11 Minutes 10 Seconds West 11.07 feet to a point; thence South 50 Degrees 31 Minutes 51 Seconds West 11.07 feet to a point; thence South 52 Degrees 52 Minutes 38 Seconds West 11.07 feet to a point; thence South 55 Degrees 13 Minutes 21 Seconds West 11.07 feet to a point; thence South 57 Degrees 34 Minutes 2 Seconds West 11.07 feet to a point; thence South 59 Degrees 54 Minutes 44 Seconds West 11.07 feet to a point; thence South 62 Degrees 15 Minutes 23 Seconds West 11.06 feet to a point; thence South 64 Degrees 36 Minutes 15 Seconds West 11.07 feet to a point; thence South 61 Degrees 28 Minutes 35 Seconds West 55.22 feet to a point; thence South 61 Degrees 59 Minutes 13 Seconds West 55.22 feet to a point; thence South 62 Degrees 29 Minutes 50 Seconds West 55.22 feet to a point; thence South 63 Degrees 0 Minutes 30 Seconds West 55.22 feet to a point; thence South 63 Degrees 31 Minutes 7 Seconds West 55.22 feet to a point; thence South 64 Degrees 1 Minutes 45 Seconds West 55.22 feet to a point; thence South 64 Degrees 32 Minutes 24 Seconds West 55.22 feet to a point; thence South 60 Degrees 59 Minutes 57 Seconds West 22.4 feet to a point; thence South 59 Degrees 51 Minutes 40 Seconds West 22.4 feet to a point; thence South 58 Degrees 43 Minutes 23

Seconds West 22.4 feet to a point; thence South 57 Degrees 35 Minutes 0 Seconds West 22.4 feet to a point; thence South 56 Degrees 26 Minutes 42 Seconds West 22.4 feet to a point; thence South 55 Degrees 18 Minutes 27 Seconds West 22.4 feet to a point; thence South 46 Degrees 3 Minutes 31 Seconds West 9.15 feet to a point; thence South 43 Degrees 0 Minutes 36 Seconds West 9.15 feet to a point; thence South 39 Degrees 57 Minutes 36 Seconds West 9.15 feet to a point; thence South 36 Degrees 54 Minutes 42 Seconds West 9.15 feet to a point; thence South 33 Degrees 51 Minutes 37 Seconds West 9.15 feet to a point; thence South 30 Degrees 48 Minutes 38 Seconds West 9.15 feet to a point; thence South 27 Degrees 45 Minutes 46 Seconds West 9.15 feet to a point; thence South 24 Degrees 42 Minutes 44 Seconds West 9.15 feet to a point; thence South 21 Degrees 39 Minutes 45 Seconds West 9.15 feet to a point; thence South 18 Degrees 36 Minutes 56 Seconds West 9.15 feet to a point; thence South 15 Degrees 33 Minutes 47 Seconds West 9.15 feet to a point; thence South 12 Degrees 30 Minutes 53 Seconds West 9.15 feet to a point; thence South 9 Degrees 27 Minutes 58 Seconds West 9.15 feet to a point; thence South 6 Degrees 24 Minutes 54 Seconds West 9.15 feet to a point; thence South 3 Degrees 21 Minutes 58 Seconds West 9.15 feet to a point; thence South 0 Degrees 18 Minutes 59 Seconds West 9.15 feet to a point; thence South 2 Degrees 43 Minutes 57 Seconds East 9.15 feet to a point; thence South 5 Degrees 46 Minutes 59 Seconds East 9.15 feet to a point; thence South 12 Degrees 2 Minutes 29 Seconds East 16.51 feet to a point; thence South 6 Degrees 20 Minutes 32 Seconds East 18.53 feet to a point; thence South 5 Degrees 3 Minutes 20 Seconds East 18.53 feet to a point; thence South 3 Degrees 46 Minutes 6 Seconds East 18.53 feet to a point; thence South 2 Degrees 29 Minutes 3 Seconds East 18.53 feet to a point; thence South 1 Degrees 11 Minutes 46 Seconds East 18.53 feet to a point; thence South 0 Degrees 5 Minutes 25 Seconds West 18.53 feet to a point; thence South 1 Degrees 22 Minutes 36 Seconds West 18.53 feet to a point; thence South 2 Degrees 5 Minutes 46 Seconds East 11.38 feet to a point; thence South 4 Degrees 33 Minutes 45 Seconds East 11.38 feet to a point; thence South 7 Degrees 1 Minutes 45 Seconds East 11.38 feet to a point; thence South 9 Degrees 29 Minutes 46 Seconds East 11.38 feet to a point; thence South 11 Degrees 57 Minutes 49 Seconds East 11.38 feet to a point; thence South 14 Degrees 25 Minutes 52 Seconds East 11.38 feet to a point; thence South 16 Degrees 53 Minutes 51 Seconds East 11.38 feet to a point; thence South 19 Degrees 21 Minutes 50 Seconds East 11.38 feet to a point; thence South 21 Degrees 49 Minutes 54 Seconds East 11.38 feet to a point; thence South 24 Degrees 17 Minutes 50 Seconds East 11.38 feet to a point; thence South 30 Degrees 45 Minutes 10 Seconds East 9.88 feet to a point; thence South 33 Degrees 19 Minutes 1 Seconds East 9.88 feet to a point; thence South 35 Degrees 52 Minutes 49 Seconds East 9.88 feet to a point; thence South 38 Degrees 26 Minutes 43 Seconds East 9.88 feet to a point; thence South 41 Degrees 0 Minutes 33 Seconds East 9.88 feet to a point; thence South 43 Degrees 34 Minutes 24 Seconds East 9.88 feet to a point; thence South 46 Degrees 8 Minutes 24 Seconds East 9.88 feet to a point; thence South 48 Degrees 42 Minutes 3 Seconds East 9.88 feet to a point; thence South 51 Degrees 16 Minutes 5 Seconds East 9.88 feet to a point; thence South 53 Degrees 49 Minutes 55 Seconds East 9.88 feet to a point; thence South 56 Degrees 23 Minutes 42 Seconds East 9.88 feet to a point; thence South 58 Degrees 57 Minutes 37 Seconds East 9.88 feet to a point; thence South 62 Degrees 41 Minutes 49 Seconds East 100.06 feet to a point; thence South 64 Degrees 17 Minutes 38 Seconds East 14.2 feet to a point; thence South 62 Degrees

26 Minutes 21 Seconds East 14.2 feet to a point; thence South 60 Degrees 35 Minutes 12 Seconds East 14.2 feet to a point; thence South 58 Degrees 43 Minutes 51 Seconds East 14.2 feet to a point; thence South 56 Degrees 52 Minutes 36 Seconds East 14.2 feet to a point; thence South 55 Degrees 1 Minutes 27 Seconds East 14.2 feet to a point; thence South 53 Degrees 10 Minutes 13 Seconds East 14.2 feet to a point; thence South 51 Degrees 18 Minutes 55 Seconds East 14.2 feet to a point; thence South 49 Degrees 27 Minutes 38 Seconds East 14.2 feet to a point; thence South 47 Degrees 36 Minutes 24 Seconds East 14.2 feet to a point; thence South 45 Degrees 45 Minutes 16 Seconds East 14.2 feet to a point; thence South 43 Degrees 53 Minutes 51 Seconds East 14.2 feet to a point; thence South 46 Degrees 16 Minutes 46 Seconds East 17.84 feet to a point; thence South 47 Degrees 55 Minutes 46 Seconds East 17.84 feet to a point; thence South 49 Degrees 34 Minutes 50 Seconds East 17.84 feet to a point; thence South 51 Degrees 13 Minutes 51 Seconds East 17.84 feet to a point; thence South 52 Degrees 53 Minutes 0 Seconds East 17.84 feet to a point; thence South 54 Degrees 32 Minutes 3 Seconds East 17.84 feet to a point; thence South 56 Degrees 11 Minutes 8 Seconds East 17.84 feet to a point; thence South 57 Degrees 50 Minutes 7 Seconds East 17.84 feet to a point; thence South 52 Degrees 16 Minutes 9 Seconds East 7.58 feet to a point; thence South 48 Degrees 30 Minutes 44 Seconds East 7.58 feet to a point; thence South 44 Degrees 45 Minutes 22 Seconds East 7.58 feet to a point; thence South 40 Degrees 59 Minutes 57 Seconds East 7.58 feet to a point; thence South 37 Degrees 59 Minutes 44 Seconds East 7.36 feet to a point; thence South 34 Degrees 18 Minutes 21 Seconds East 7.36 feet to a point; thence South 30 Degrees 37 Minutes 2 Seconds East 7.36 feet to a point; thence South 26 Degrees 55 Minutes 38 Seconds East 7.36 feet to a point; thence South 23 Degrees 14 Minutes 15 Seconds East 7.36 feet to a point; thence South 19 Degrees 32 Minutes 53 Seconds East 7.36 feet to a point; thence South 15 Degrees 51 Minutes 31 Seconds East 7.36 feet to a point; thence South 12 Degrees 10 Minutes 11 Seconds East 7.36 feet to a point; thence South 8 Degrees 28 Minutes 43 Seconds East 7.36 feet to a point; thence South 4 Degrees 47 Minutes 25 Seconds East 7.36 feet to a point; thence South 1 Degrees 6 Minutes 4 Seconds East 7.36 feet to a point; thence South 0 Degrees 5 Minutes 36 Seconds West 13.7 feet to a point; thence South 2 Degrees 10 Minutes 38 Seconds West 13.7 feet to a point; thence South 4 Degrees 15 Minutes 40 Seconds West 13.7 feet to a point; thence South 6 Degrees 20 Minutes 48 Seconds West 13.7 feet to a point; thence South 8 Degrees 25 Minutes 51 Seconds West 13.7 feet to a point; thence South 10 Degrees 30 Minutes 50 Seconds West 13.7 feet to a point; thence South 12 Degrees 35 Minutes 53 Seconds West 13.7 feet to a point; thence South 14 Degrees 40 Minutes 59 Seconds West 13.7 feet to a point; thence South 16 Degrees 46 Minutes 6 Seconds West 13.7 feet to a point; thence South 18 Degrees 45 Minutes 18 Seconds West 31.29 feet to a point; thence South 17 Degrees 57 Minutes 15 Seconds West 31.29 feet to a point; thence South 17 Degrees 9 Minutes 4 Seconds West 31.29 feet to a point; thence South 16 Degrees 21 Minutes 0 Seconds West 31.29 feet to a point; thence South 15 Degrees 32 Minutes 52 Seconds West 31.29 feet to a point; thence South 14 Degrees 44 Minutes 46 Seconds West 31.29 feet to a point; thence South 14 Degrees 11 Minutes 25 Seconds West 28.52 feet to a point; thence South 13 Degrees 27 Minutes 16 Seconds West 28.52 feet to a point; thence South 12 Degrees 43 Minutes 13 Seconds West 28.52 feet to a point; thence South 11 Degrees 59 Minutes 5 Seconds West 28.52 feet to a point; thence South 11 Degrees 15 Minutes 0 Seconds West 28.52 feet to a point; thence South 10

Degrees 30 Minutes 56 Seconds West 28.52 feet to a point; thence South 12 Degrees 40 Minutes 8 Seconds West 231.51 feet to a point; thence South 14 Degrees 22 Minutes 7 Seconds West 298.8 feet to a point; thence South 14 Degrees 22 Minutes 7 Seconds West 134.78 feet to a point; thence South 14 Degrees 22 Minutes 7 Seconds West 249.57 feet to a point; thence South 14 Degrees 22 Minutes 7 Seconds West 262.67 feet to a point; thence South 89 Degrees 51 Minutes 27 Seconds West 281.17 feet to a point; thence South 2 Degrees 19 Minutes 15 Seconds West 351.83 feet to a point; thence North 89 Degrees 47 Minutes 54 Seconds West 333.06 feet to a point; thence South 02 Degrees 07 Minutes 36 Seconds West 452.57 feet to a point; thence North 74 Degrees 25 Minutes 10 Seconds West 1523.88 feet to a point; thence North 2 Degrees 53 Minutes 16 Seconds West 1402.87 feet to a point; thence North 8 Degrees 24 Minutes 30 Seconds West 642.36 feet to a point; thence North 2 Degrees 3 Minutes 11 Seconds East 3656.99 feet to a point; thence South 88 Degrees 7 Minutes 23 Seconds East 306.23 feet to a point; thence North 1 Degrees 52 Minutes 28 Seconds East 87.86 feet to a point; thence North 72 Degrees 48 Minutes 56 Seconds West 199.21 feet to a point; thence South 1 Degrees 47 Minutes 46 Seconds West 78.51 feet to a point; thence North 88 Degrees 5 Minutes 59 Seconds West 114.01 feet to a point; thence North 1 Degrees 47 Minutes 45 Seconds East 841.01 feet to a point; thence North 1 Degrees 11 Minutes 59 Seconds East 477.55 feet back to the Point of True Beginning and containing 394.93 acres more or less.

3. That this ordinance shall be published as provided by law, and become effective upon its publication as required by law.

4. That the Mayor and City Clerk of the City of Huntsville, Alabama, are hereby authorized, requested, and directed for and on behalf of the governing body of the City to file a description of the property or territory herein annexed in the Office of the Judge of Probate of Limestone County, Alabama.

ADOPTED this the _____ day of _____, 2025.

President of the City Council of
the City of Huntsville, Alabama.

APPROVED this the _____ day of _____, 2025.

Mayor of the City of Huntsville,
Alabama

STATE OF ALABAMA)
)
COUNTY OF MADISON)

**PETITION FOR ANNEXATION TO THE CITY OF
HUNTSVILLE, ALABAMA, PURSUANT TO SECTIONS 11-42-20 THROUGH
11-42-24 INCLUSIVE, CODE OF ALA. 1975 (AS AMENDED)**

**TO: The City Clerk of the City of Huntsville, Alabama, and the
 City Council of the City of Huntsville, Alabama**

**FROM: GL McCrary Farms, LLC, by G. Laurence McCrary, III and
 Margaret Anne Crumlish, as its Managers; and McCrary North, LLC
 by G. Laurence McCrary, III and Margaret Anne Crumlish, as its
 Members (hereinafter referred to as “the petitioners”)**

A. The Petitioners do hereby sign and file with the City Clerk of the City of Huntsville, Alabama, this written petition requesting that the real property or territory hereinafter described, which real property or territory is hereinafter referred to as “the Property”, be annexed to the City of Huntsville, Alabama, under the authority of and pursuant to Sections 11-42-20 through 11-42-24 of the Code of Alabama 1975; and in support thereof do hereby certify as follows:

1. That the Petitioners are the owners of the Property, as the term “owner” is defined by Section 11-42-20, Code of Alabama 1975.
2. That the Property is situated in **Limestone County, Alabama**, and is accurately described on the attached Exhibit “A”, which exhibit is incorporated herein by reference.
3. That the Petitioners have the right and authority to make and file this petition for annexation.
4. That the Property is contiguous to the existing corporate limits of the City of Huntsville, Alabama.
5. That the Property does not lie within the corporate limits or police jurisdiction of any other municipality.
6. That the Petitioners have attached hereto as Exhibit “B”, which exhibit is incorporated herein by reference, and filed herewith a map of the Property showing its relationship to the corporate limits of the City of Huntsville, Alabama, which said map is further identified as being entitled "Westmoore Landing Property to be Annexed."

B. This petition may be signed in any number of counterparts, each of which shall be deemed an original, and all of which taken together shall constitute one and the same petition.

THE FOREGOING CONSIDERED, we, the Petitioners hereby petition and request that the City Council of the City of Huntsville, Alabama, adopt an ordinance assenting to the annexation of the Property to the City of Huntsville, Alabama, all in accordance with the statutes herein provided.

IN WITNESS WHEREOF, we, the undersigned Petitioners have hereunto subscribed our names as of the 27th day of December, 2024.

PETITIONERS:

GL McCrary Farms, LLC

Signature: _____

G. Laurence McCrary, III

Signature: _____

Margaret Anne Crumlish

As its: **Managers**

McCrary North, LLC

Signature: _____

G. Laurence McCrary, III

Signature: _____

Margaret Anne Crumlish

As its: **Members**

STATE OF Alabama)
)
COUNTY OF Madison)

I, the undersigned, a Notary Public in and for said County in said State, hereby certify that G. Laurence McCrary, III, whose name is signed to the foregoing annexation petition and who are known to me, acknowledged before me on this date that, being informed of the contents of said petition, he executed the same voluntarily as of the day the same bears date.

Given under my hand and official seal of office, this the 27th day of Dec.
2024.

Celesta Freeman (SEAL)
NOTARY PUBLIC



STATE OF Alabama)
)
COUNTY OF Madison)

I, the undersigned, a Notary Public in and for said County in said State, hereby certify that Margaret Anne Crumlish, whose name is signed to the foregoing annexation petition and who are known to me, acknowledged before me on this date that, being informed of the contents of said petition, she executed the same voluntarily as of the day the same bears date.

Given under my hand and official seal of office, this the 27th day of Dec.
2024.

Celesta Freeman (SEAL)
NOTARY PUBLIC



Exhibit "A"
(Legal Description of the Property)

All that part of Sections 06, 07 and 18, Township 5 South, Range 3 West of the Huntsville Meridian, Limestone County, Alabama more particularly described as beginning at a point located at the southwest corner of said Section 06; thence North 1 Degrees 42 Minutes 30 Seconds East 347.33 feet to a point; said point is further described as the Point of True Beginning; thence South 86 Degrees 44 Minutes 3 Seconds East 314.47 feet to a point; thence South 46 Degrees 48 Minutes 28 Seconds East 571.02 feet to a point; thence South 88 Degrees 34 Minutes 30 Seconds East 1133.8 feet to a point; thence South 88 Degrees 33 Minutes 59 Seconds East 189.5 feet to a point; thence South 4 Degrees 11 Minutes 10 Seconds West 195.62 feet to a point; thence South 0 Degrees 33 Minutes 2 Seconds West 290.67 feet to a point; thence South 3 Degrees 47 Minutes 43 Seconds West 168.97 feet to a point; thence South 23 Degrees 20 Minutes 55 Seconds East 97.07 feet to a point; thence South 29 Degrees 6 Minutes 18 Seconds East 16.2 feet to a point; thence South 30 Degrees 44 Minutes 58 Seconds East 16.2 feet to a point; thence South 28 Degrees 4 Minutes 52 Seconds East 293.31 feet to a point; thence South 87 Degrees 23 Minutes 31 Seconds East 239.89 feet to a point; thence South 0 Degrees 18 Minutes 22 Seconds West 268.82 feet to a point; thence South 89 Degrees 8 Minutes 40 Seconds East 230.48 feet to a point; thence South 24 Degrees 22 Minutes 9 Seconds East 1247.71 feet to a point; thence South 1 Degrees 37 Minutes 21 Seconds West 521.37 feet to a point; thence North 88 Degrees 52 Minutes 17 Seconds West 527.77 feet to a point; thence South 2 Degrees 30 Minutes 36 Seconds West 51.62 feet to a point; thence South 1 Degrees 58 Minutes 33 Seconds West 51.62 feet to a point; thence South 1 Degrees 26 Minutes 25 Seconds West 51.62 feet to a point; thence South 0 Degrees 54 Minutes 20 Seconds West 51.62 feet to a point; thence South 0 Degrees 22 Minutes 15 Seconds West 51.62 feet to a point; thence South 0 Degrees 9 Minutes 50 Seconds East 51.62 feet to a point; thence South 4 Degrees 38 Minutes 29 Seconds East 15.44 feet to a point; thence South 2 Degrees 59 Minutes 21 Seconds East 15.44 feet to a point; thence South 1 Degrees 20 Minutes 17 Seconds East 15.44 feet to a point; thence South 0 Degrees 18 Minutes 51 Seconds West 15.44 feet to a point; thence South 1 Degrees 57 Minutes 51 Seconds West 15.44 feet to a point; thence South 3 Degrees 37 Minutes 2 Seconds West 15.44 feet to a point; thence South 5 Degrees 16 Minutes 6 Seconds West 15.44 feet to a point; thence South 6 Degrees 55 Minutes 12 Seconds West 15.44 feet to a point; thence South 8 Degrees 34 Minutes 18 Seconds West 15.44 feet to a point; thence South 13 Degrees 25 Minutes 34 Seconds West 9.5 feet to a point; thence South 16 Degrees 20 Minutes 38 Seconds West 9.5 feet to a point; thence South 19 Degrees 15 Minutes 40 Seconds West 9.5 feet to a point; thence South 22 Degrees 10 Minutes 20 Seconds West 9.5 feet to a point; thence South 25 Degrees 5 Minutes 16 Seconds West 9.5 feet to a

point; thence South 28 Degrees 0 Minutes 15 Seconds West 9.5 feet to a point; thence South 30 Degrees 55 Minutes 5 Seconds West 9.5 feet to a point; thence South 33 Degrees 50 Minutes 2 Seconds West 9.5 feet to a point; thence South 36 Degrees 45 Minutes 3 Seconds West 9.5 feet to a point; thence South 39 Degrees 39 Minutes 56 Seconds West 9.5 feet to a point; thence South 42 Degrees 34 Minutes 43 Seconds West 9.5 feet to a point; thence South 45 Degrees 29 Minutes 38 Seconds West 9.5 feet to a point; thence South 45 Degrees 50 Minutes 27 Seconds West 11.07 feet to a point; thence South 48 Degrees 11 Minutes 10 Seconds West 11.07 feet to a point; thence South 50 Degrees 31 Minutes 51 Seconds West 11.07 feet to a point; thence South 52 Degrees 52 Minutes 38 Seconds West 11.07 feet to a point; thence South 55 Degrees 13 Minutes 21 Seconds West 11.07 feet to a point; thence South 57 Degrees 34 Minutes 2 Seconds West 11.07 feet to a point; thence South 59 Degrees 54 Minutes 44 Seconds West 11.07 feet to a point; thence South 62 Degrees 15 Minutes 23 Seconds West 11.06 feet to a point; thence South 64 Degrees 36 Minutes 15 Seconds West 11.07 feet to a point; thence South 61 Degrees 28 Minutes 35 Seconds West 55.22 feet to a point; thence South 61 Degrees 59 Minutes 13 Seconds West 55.22 feet to a point; thence South 62 Degrees 29 Minutes 50 Seconds West 55.22 feet to a point; thence South 63 Degrees 0 Minutes 30 Seconds West 55.22 feet to a point; thence South 63 Degrees 31 Minutes 7 Seconds West 55.22 feet to a point; thence South 64 Degrees 1 Minutes 45 Seconds West 55.22 feet to a point; thence South 64 Degrees 32 Minutes 24 Seconds West 55.22 feet to a point; thence South 60 Degrees 59 Minutes 57 Seconds West 22.4 feet to a point; thence South 59 Degrees 51 Minutes 40 Seconds West 22.4 feet to a point; thence South 58 Degrees 43 Minutes 23 Seconds West 22.4 feet to a point; thence South 57 Degrees 35 Minutes 0 Seconds West 22.4 feet to a point; thence South 56 Degrees 26 Minutes 42 Seconds West 22.4 feet to a point; thence South 55 Degrees 18 Minutes 27 Seconds West 22.4 feet to a point; thence South 46 Degrees 3 Minutes 31 Seconds West 9.15 feet to a point; thence South 43 Degrees 0 Minutes 36 Seconds West 9.15 feet to a point; thence South 39 Degrees 57 Minutes 36 Seconds West 9.15 feet to a point; thence South 36 Degrees 54 Minutes 42 Seconds West 9.15 feet to a point; thence South 33 Degrees 51 Minutes 37 Seconds West 9.15 feet to a point; thence South 30 Degrees 48 Minutes 38 Seconds West 9.15 feet to a point; thence South 27 Degrees 45 Minutes 46 Seconds West 9.15 feet to a point; thence South 24 Degrees 42 Minutes 44 Seconds West 9.15 feet to a point; thence South 21 Degrees 39 Minutes 45 Seconds West 9.15 feet to a point; thence South 18 Degrees 36 Minutes 56 Seconds West 9.15 feet to a point; thence South 15 Degrees 33 Minutes 47 Seconds West 9.15 feet to a point; thence South 12 Degrees 30 Minutes 53 Seconds West 9.15 feet to a point; thence South 9 Degrees 27 Minutes 58 Seconds West 9.15 feet to a point; thence South 6 Degrees 24 Minutes 54 Seconds West 9.15 feet to a point; thence South 3 Degrees 21 Minutes 58 Seconds West 9.15 feet to a point; thence South 0 Degrees 18 Minutes 59 Seconds West 9.15 feet to a point; thence South 2 Degrees 43 Minutes 57 Seconds East 9.15 feet to

a point; thence South 5 Degrees 46 Minutes 59 Seconds East 9.15 feet to a point; thence South 12 Degrees 2 Minutes 29 Seconds East 16.51 feet to a point; thence South 6 Degrees 20 Minutes 32 Seconds East 18.53 feet to a point; thence South 5 Degrees 3 Minutes 20 Seconds East 18.53 feet to a point; thence South 3 Degrees 46 Minutes 6 Seconds East 18.53 feet to a point; thence South 2 Degrees 29 Minutes 3 Seconds East 18.53 feet to a point; thence South 1 Degrees 11 Minutes 46 Seconds East 18.53 feet to a point; thence South 0 Degrees 5 Minutes 25 Seconds West 18.53 feet to a point; thence South 1 Degrees 22 Minutes 36 Seconds West 18.53 feet to a point; thence South 2 Degrees 5 Minutes 46 Seconds East 11.38 feet to a point; thence South 4 Degrees 33 Minutes 45 Seconds East 11.38 feet to a point; thence South 7 Degrees 1 Minutes 45 Seconds East 11.38 feet to a point; thence South 9 Degrees 29 Minutes 46 Seconds East 11.38 feet to a point; thence South 11 Degrees 57 Minutes 49 Seconds East 11.38 feet to a point; thence South 14 Degrees 25 Minutes 52 Seconds East 11.38 feet to a point; thence South 16 Degrees 53 Minutes 51 Seconds East 11.38 feet to a point; thence South 19 Degrees 21 Minutes 50 Seconds East 11.38 feet to a point; thence South 21 Degrees 49 Minutes 54 Seconds East 11.38 feet to a point; thence South 24 Degrees 17 Minutes 50 Seconds East 11.38 feet to a point; thence South 30 Degrees 45 Minutes 10 Seconds East 9.88 feet to a point; thence South 33 Degrees 19 Minutes 1 Seconds East 9.88 feet to a point; thence South 35 Degrees 52 Minutes 49 Seconds East 9.88 feet to a point; thence South 38 Degrees 26 Minutes 43 Seconds East 9.88 feet to a point; thence South 41 Degrees 0 Minutes 33 Seconds East 9.88 feet to a point; thence South 43 Degrees 34 Minutes 24 Seconds East 9.88 feet to a point; thence South 46 Degrees 8 Minutes 24 Seconds East 9.88 feet to a point; thence South 48 Degrees 42 Minutes 3 Seconds East 9.88 feet to a point; thence South 51 Degrees 16 Minutes 5 Seconds East 9.88 feet to a point; thence South 53 Degrees 49 Minutes 55 Seconds East 9.88 feet to a point; thence South 56 Degrees 23 Minutes 42 Seconds East 9.88 feet to a point; thence South 58 Degrees 57 Minutes 37 Seconds East 9.88 feet to a point; thence South 62 Degrees 41 Minutes 49 Seconds East 100.06 feet to a point; thence South 64 Degrees 17 Minutes 38 Seconds East 14.2 feet to a point; thence South 62 Degrees 26 Minutes 21 Seconds East 14.2 feet to a point; thence South 60 Degrees 35 Minutes 12 Seconds East 14.2 feet to a point; thence South 58 Degrees 43 Minutes 51 Seconds East 14.2 feet to a point; thence South 56 Degrees 52 Minutes 36 Seconds East 14.2 feet to a point; thence South 55 Degrees 1 Minutes 27 Seconds East 14.2 feet to a point; thence South 53 Degrees 10 Minutes 13 Seconds East 14.2 feet to a point; thence South 51 Degrees 18 Minutes 55 Seconds East 14.2 feet to a point; thence South 49 Degrees 27 Minutes 38 Seconds East 14.2 feet to a point; thence South 47 Degrees 36 Minutes 24 Seconds East 14.2 feet to a point; thence South 45 Degrees 45 Minutes 16 Seconds East 14.2 feet to a point; thence South 43 Degrees 53 Minutes 51 Seconds East 14.2 feet to a point; thence South 46 Degrees 16 Minutes 46 Seconds East 17.84 feet to a point; thence South 47 Degrees 55 Minutes 46 Seconds East 17.84 feet to a

point; thence South 49 Degrees 34 Minutes 50 Seconds East 17.84 feet to a point; thence South 51 Degrees 13 Minutes 51 Seconds East 17.84 feet to a point; thence South 52 Degrees 53 Minutes 0 Seconds East 17.84 feet to a point; thence South 54 Degrees 32 Minutes 3 Seconds East 17.84 feet to a point; thence South 56 Degrees 11 Minutes 8 Seconds East 17.84 feet to a point; thence South 57 Degrees 50 Minutes 7 Seconds East 17.84 feet to a point; thence South 52 Degrees 16 Minutes 9 Seconds East 7.58 feet to a point; thence South 48 Degrees 30 Minutes 44 Seconds East 7.58 feet to a point; thence South 44 Degrees 45 Minutes 22 Seconds East 7.58 feet to a point; thence South 40 Degrees 59 Minutes 57 Seconds East 7.58 feet to a point; thence South 37 Degrees 59 Minutes 44 Seconds East 7.36 feet to a point; thence South 34 Degrees 18 Minutes 21 Seconds East 7.36 feet to a point; thence South 30 Degrees 37 Minutes 2 Seconds East 7.36 feet to a point; thence South 26 Degrees 55 Minutes 38 Seconds East 7.36 feet to a point; thence South 23 Degrees 14 Minutes 15 Seconds East 7.36 feet to a point; thence South 19 Degrees 32 Minutes 53 Seconds East 7.36 feet to a point; thence South 15 Degrees 51 Minutes 31 Seconds East 7.36 feet to a point; thence South 12 Degrees 10 Minutes 11 Seconds East 7.36 feet to a point; thence South 8 Degrees 28 Minutes 43 Seconds East 7.36 feet to a point; thence South 4 Degrees 47 Minutes 25 Seconds East 7.36 feet to a point; thence South 1 Degrees 6 Minutes 4 Seconds East 7.36 feet to a point; thence South 0 Degrees 5 Minutes 36 Seconds West 13.7 feet to a point; thence South 2 Degrees 10 Minutes 38 Seconds West 13.7 feet to a point; thence South 4 Degrees 15 Minutes 40 Seconds West 13.7 feet to a point; thence South 6 Degrees 20 Minutes 48 Seconds West 13.7 feet to a point; thence South 8 Degrees 25 Minutes 51 Seconds West 13.7 feet to a point; thence South 10 Degrees 30 Minutes 50 Seconds West 13.7 feet to a point; thence South 12 Degrees 35 Minutes 53 Seconds West 13.7 feet to a point; thence South 14 Degrees 40 Minutes 59 Seconds West 13.7 feet to a point; thence South 16 Degrees 46 Minutes 6 Seconds West 13.7 feet to a point; thence South 18 Degrees 45 Minutes 18 Seconds West 31.29 feet to a point; thence South 17 Degrees 57 Minutes 15 Seconds West 31.29 feet to a point; thence South 17 Degrees 9 Minutes 4 Seconds West 31.29 feet to a point; thence South 16 Degrees 21 Minutes 0 Seconds West 31.29 feet to a point; thence South 15 Degrees 32 Minutes 52 Seconds West 31.29 feet to a point; thence South 14 Degrees 44 Minutes 46 Seconds West 31.29 feet to a point; thence South 14 Degrees 11 Minutes 25 Seconds West 28.52 feet to a point; thence South 13 Degrees 27 Minutes 16 Seconds West 28.52 feet to a point; thence South 12 Degrees 43 Minutes 13 Seconds West 28.52 feet to a point; thence South 11 Degrees 59 Minutes 5 Seconds West 28.52 feet to a point; thence South 11 Degrees 15 Minutes 0 Seconds West 28.52 feet to a point; thence South 10 Degrees 30 Minutes 56 Seconds West 28.52 feet to a point; thence South 12 Degrees 40 Minutes 8 Seconds West 231.51 feet to a point; thence South 14 Degrees 22 Minutes 7 Seconds West 298.8 feet to a point; thence South 14 Degrees 22 Minutes 7 Seconds West 134.78 feet to a point; thence South 14 Degrees 22 Minutes 7 Seconds West 249.57 feet to a point;

thence South 14 Degrees 22 Minutes 7 Seconds West 262.67 feet to a point; thence South 89 Degrees 51 Minutes 27 Seconds West 281.17 feet to a point; thence South 2 Degrees 19 Minutes 15 Seconds West 351.83 feet to a point; thence North 89 Degrees 47 Minutes 54 Seconds West 333.06 feet to a point; thence South 02 Degrees 07 Minutes 36 Seconds West 452.57 feet to a point; thence North 74 Degrees 25 Minutes 10 Seconds West 1523.88 feet to a point; thence North 2 Degrees 53 Minutes 16 Seconds West 1402.87 feet to a point; thence North 8 Degrees 24 Minutes 30 Seconds West 642.36 feet to a point; thence North 2 Degrees 3 Minutes 11 Seconds East 3656.99 feet to a point; thence South 88 Degrees 7 Minutes 23 Seconds East 306.23 feet to a point; thence North 1 Degrees 52 Minutes 28 Seconds East 87.86 feet to a point; thence North 72 Degrees 48 Minutes 56 Seconds West 199.21 feet to a point; thence South 1 Degrees 47 Minutes 46 Seconds West 78.51 feet to a point; thence North 88 Degrees 5 Minutes 59 Seconds West 114.01 feet to a point; thence North 1 Degrees 47 Minutes 45 Seconds East 841.01 feet to a point; thence North 1 Degrees 11 Minutes 59 Seconds East 477.55 feet back to the Point of True Beginning and containing 394.93 acres more or less.

EXHIBIT B: WESTMOORE LANDING PROPERTY TO BE ANNEXED

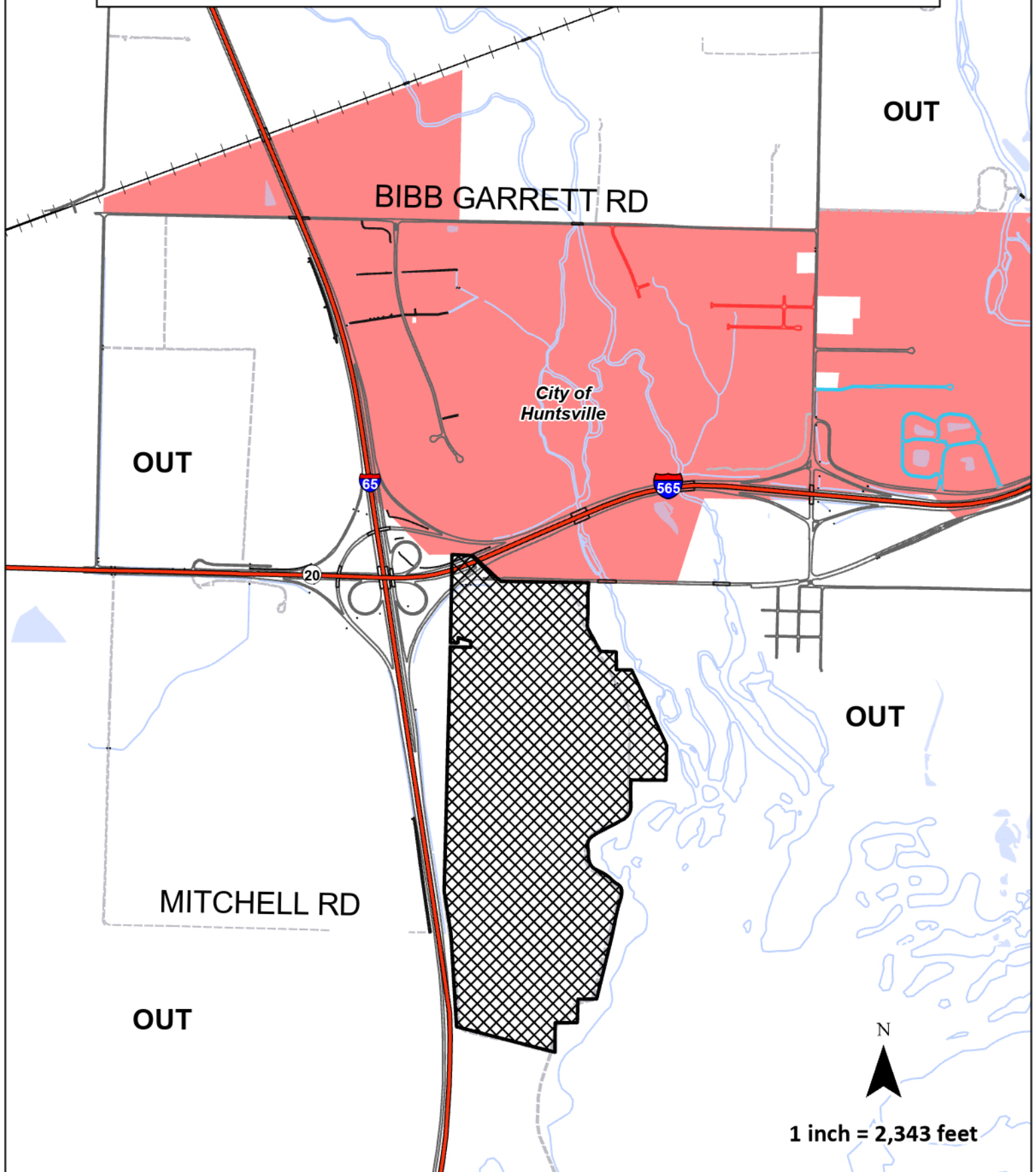

ANNEXATION SUMMARY: WESTMOORE LANDING

December 18, 2024

PETITIONER: GL McCrary Farms, LLC, by G. Laurence McCrary, III and Margaret Anne Crumlish, as its Managers; and McCrary North, LLC by G. Laurence McCrary, III and Margaret Anne Crumlish, as its Members

LOCATION: On the south side of AL Hwy 20 and east of I-65
Township 5 South, Range 3 West, Sections 06, 07 and 18
Arrowhead Landing Rd, Mooresville, AL 35649

ACREAGE: 394.93 acres

REASON FOR
REQUEST: City Services

ANNEXATION GUIDELINES: Westmoore Landing

1. Annexations that would fill in or make more regular the existing corporate limits should be strongly encouraged.

WOULD CONTINUE ONGOING ANNEXATIONS IN THIS AREA

2. The remaining tax islands should be annexed when ownership changes and redevelopment occurs....

NOT A TAX ISLAND

3. Annexations of land in subdivisions....

NOT PART OF A SUBDIVISION

4. Corridors are discouraged....

NOT A CORRIDOR

5. Point-to-point annexations should be discouraged....

NOT A POINT-TO-POINT CONNECTION

6. Owners living on land expected to be annexed within the ninety-day period preceding a municipal election....

NO MUNICIPAL ELECTION AT TIME OF ANNEXATION

7. Land which is known to be contaminated should not be annexed until such danger has been mitigated.

NO KNOWN CONTAMINATION

8. The annexation of land that would contribute to the city's economic development through an increase in taxes....

RESIDENTIAL AND COMMERCIAL LAND

9. The city should require petitions for annexation referenda to satisfy additional conditions....

NOT A REFERENDA

10. City planners will explain to all annexation petitioners the policies under which services are provided.

CITY OWNED PROPERTY

STATEMENT REGARDING PROVISION OF CITY SERVICES TO NEWLY ANNEXED LANDS

City services will be provided to all newly annexed lands according to the same policies that already govern in Huntsville. This means that Huntsville police and fire departments will respond to calls; garbage and trash will be collected by city sanitation; and school children will attend city rather than county schools. Transportation for students attending the city schools will be the responsibility of their parents. All applicable city ordinances will be enforced including the implementation of zoning regulations. Please note that the National agency that established the rating schedule for fire insurance premiums (ISO) assigns a higher rate to property that is over 5 road miles from their responding fire station and/or over 1000 feet from a fire hydrant.

Water service is provided by Huntsville Utilities; however if the annexed land is already served by another water authority, the existing situation should be expected to continue until such time as development pressure or legal agreements between water authorities makes it feasible or possible for Huntsville Utilities to assume control of the water lines or extend new mains. The cost of main extensions usually are borne by the property owner.

Likewise, it has long been city policy to expand sanitary sewer service on a cost benefit basis. This policy applies to all land within the city regardless of its annexation date. In addition, the city has adopted a capital improvement plan to guide investment in infrastructure. In order for an area to be considered for road construction, drainage improvements, recreational or community facilities, new fire stations, or sanitary sewer extension, the area must be in the city and then must be prioritized according to need. Newly annexed land will be accorded the same consideration as other city lands.

Lastly, it is important to understand that those autonomous boards, agencies and utilities that have authority over the delivery of specific public services set their own policies and procedures.

* * * * *

I have read the above statement governing the delivery of city services to lands annexed into the city of Huntsville, and I agree to these conditions as they may pertain to any of my lands that are annexed.

Petitioner  Date 12/18/24
Petitioner _____ Date _____

STATEMENT REGARDING PROVISION OF CITY SERVICES TO NEWLY ANNEXED LANDS

City services will be provided to all newly annexed lands according to the same policies that already govern in Huntsville. This means that Huntsville police and fire departments will respond to calls; garbage and trash will be collected by city sanitation; and school children will attend city rather than county schools. Transportation for students attending the city schools will be the responsibility of their parents. All applicable city ordinances will be enforced including the implementation of zoning regulations. Please note that the National agency that established the rating schedule for fire insurance premiums (ISO) assigns a higher rate to property that is over 5 road miles from their responding fire station and/or over 1000 feet from a fire hydrant.

Water service is provided by Huntsville Utilities; however if the annexed land is already served by another water authority, the existing situation should be expected to continue until such time as development pressure or legal agreements between water authorities makes it feasible or possible for Huntsville Utilities to assume control of the water lines or extend new mains. The cost of main extensions usually are borne by the property owner.

Likewise, it has long been city policy to expand sanitary sewer service on a cost benefit basis. This policy applies to all land within the city regardless of its annexation date. In addition, the city has adopted a capital improvement plan to guide investment in infrastructure. In order for an area to be considered for road construction, drainage improvements, recreational or community facilities, new fire stations, or sanitary sewer extension, the area must be in the city and then must be prioritized according to need. Newly annexed land will be accorded the same consideration as other city lands.

Lastly, it is important to understand that those autonomous boards, agencies and utilities that have authority over the delivery of specific public services set their own policies and procedures.

* * * * *

I have read the above statement governing the delivery of city services to lands annexed into the city of Huntsville, and I agree to these conditions as they may pertain to any of my lands that are annexed.

Petitioner  Date 1-2-2025

Petitioner _____ Date _____

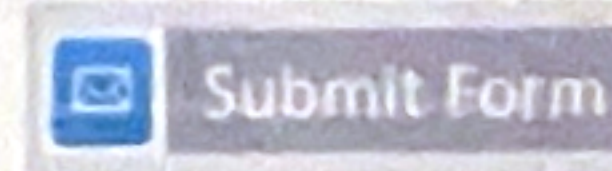
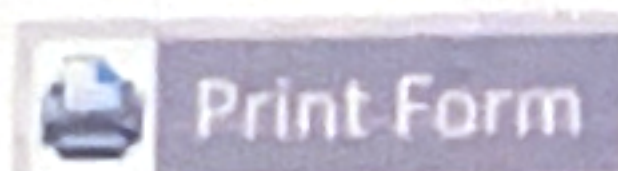

STATEMENT REGARDING PROVISION OF CITY SERVICES TO NEWLY ANNEXED LANDS

City services will be provided to all newly annexed lands according to the same policies that already govern in Huntsville. This means that Huntsville police and fire departments will respond to calls; garbage and trash will be collected by city sanitation; and school children will attend city rather than county schools. Transportation for students attending the city schools will be the responsibility of their parents. All applicable city ordinances will be enforced including the implementation of zoning regulations. Please note that the National agency that established the rating schedule for fire insurance premiums (ISO) assigns a higher rate to property that is over 5 road miles from their responding fire station and/or over 1000 feet from a fire hydrant.

Water service is provided by Huntsville Utilities; however if the annexed land is already served by another water authority, the existing situation should be expected to continue until such time as development pressure or legal agreements between water authorities makes it feasible or possible for Huntsville Utilities to assume control of the water lines or extend new mains. The cost of main extensions usually are borne by the property owner.

Likewise, it has long been city policy to expand sanitary sewer service on a cost benefit basis. This policy applies to all land within the city regardless of its annexation date. In addition, the city has adopted a capital improvement plan to guide investment in infrastructure. In order for an area to be considered for road construction, drainage improvements, recreational or community facilities, new fire stations, or sanitary sewer extension, the area must be in the city and then must be prioritized according to need. Newly annexed land will be accorded the same consideration as other city lands.

Lastly, it is important to understand that those autonomous boards, agencies and utilities that have authority over the delivery of specific public services set their own policies and procedures.

* * * * *

I have read the above statement governing the delivery of city services to lands annexed into the city of Huntsville, and I agree to these conditions as they may pertain to any of my lands that are annexed.

Petitioner  Date 1-2-2025
Petitioner  Date 1/2/25

